



Quality Access Doors- FAST!

SUBMITTAL/TECHNICAL DATA SHEET

STANDARD OPTIONS

MATERIAL:
10 gauge cold rolled steel plate
2" x 2" x 3/16" thick angle frame

HINGE:
3" x 3" (13 Ga Steel) heavy duty butt hinges 13 gauge cold rolled steel

LOCK / LATCH:
As per customer's request

FINISH:
High quality white powder coat primer

PACKAGING:
Individually wrapped, 1 per box

OPTIONS AVAILABLE

- LOCK / LATCH:**
- Mortise preparation for detention lock
 - Mortise preparation (cylinder optional)
 - Mortise deadbolt lock

For a complete list of options visit www.BestAccessDoors.ca

Scan or Click



To view Pricing and Additional Product Info.

LEED READY: THIS PRODUCT CONTRIBUTES TO LEED® CREDITS



SKU: **BAG-PHS**

HIGH SECURITY ACCESS DOOR

FOR ALL SURFACE TYPES



INSTALLATION

>> [CLICK TO VIEW ADDITIONAL DETAILS AND PRICING <<](#)

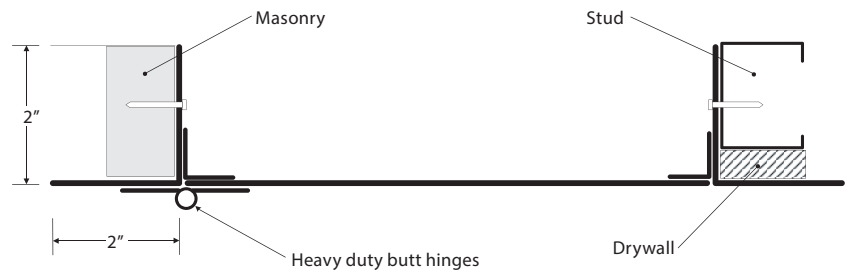

DIMENSIONS AND APPEARANCE

DOOR SIZE W x H INCHES (MM)	WEIGHT	
	LBS	KG
12 x 12 (304 x 304)	8	3.6
16 x 16 (406 x 406)	12	5.5
18 x 18 (457 x 457)	14	6.4
24 x 24 (609 x 609)	22	10
30 x 30 (762 x 762)	30	13.6
24 x 36 (609 x 914)	29	13.2
36 x 36 (914 x 914)	39	17.7

LOCK AND CYLINDER OPTIONAL

ROUGH WALL OPENING IS DOOR SIZE + 1/4" OR + 6mm

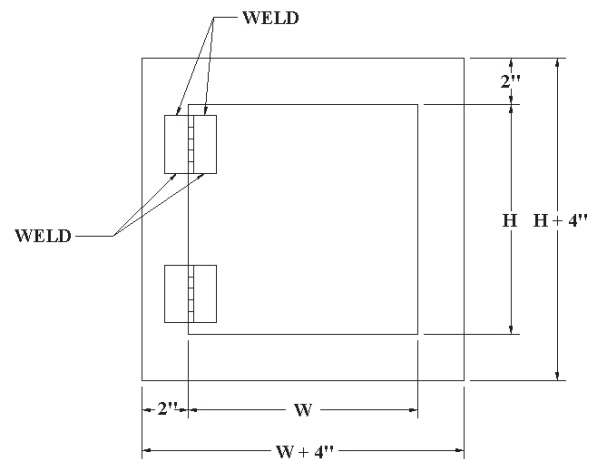

PROJECT DATA

Custom Sizes Available - Fast!

PROJECT NAME :	QTY	W	H	OPTIONS
ARCHITECT :				
DEALER :				
CONTRACTOR :				
LOCATION :	SPECIAL INSTRUCTIONS :			
DATE :				
TAGGING INSTRUCTIONS :	SUBMITTAL APPROVAL : (signature or stamp)			

TELEPHONE:
1-800-483-0823
FAX:
1-888-828-6021

385 WILSON STREET EAST,
SUITE 302
ANCASTER, ON, L9G 2C1
CANADA

WEBSITE:
www.BestAccessDoors.ca
E-MAIL:
info@bestaccessdoors.ca

