



Quality Access Doors- FAST!

# SUBMITTAL/TECHNICAL DATA SHEET

SKU: **BAC-GFRC-ROUND**

## POP-OUT ROUND ACCESS PANEL

FOR CEILINGS



### DESCRIPTIONS

These Access Panels made from glass fiber reinforced gypsum and 70% post-consumer recycled glass for a sustainable design that blends seamlessly into your walls and ceilings. Consisting of a surround frame and either a Pop-Out or Concealed Hinged Door, Seamless GFRG Access Door Panels are perfect for jobs where Access is required at regular intervals.

### FEATURES

- Tapered edge for tape joint
- Single trade installation
- Reduce labor costs
- Zero mold & fungus growth
- No shrinking, cracking, sagging or rusting
- Blends seamlessly into surrounding drywall
- Concealed hinge
- Easily textured
- Moisture resistant
- Lightweight

### SPECIFICATIONS

SHELL THICKNESS: 1/8" to 3/16"

FASLENER TESL PULL OUT (WOOD STUD) : 525 lb avg.

FASLENER TEST PULL OUT (MELAL STUD): 215 lb avg.

FASLENER PUSH THROUGH TEST: 350 lb avg.

FUEL CONTRIBUTION (ASTM E84-80): 0

FLAME SPREAD (ASTM E84-80): 0

SMOKE INDEX (ASTM E84-80): 0

COMBUSTION (ASTM E84-80): Non-combustible

CLASS A NON-RATED: -

CSI CODE: CSI #08310

For a complete list of options visit [www.BestAccessDoors.ca](http://www.BestAccessDoors.ca)

### DIMENSIONS AND APPEARANCE

>> CLICK TO VIEW ADDITIONAL DETAILS AND PRICING <<

#### STANDARD SIZES:

STOCK	ACCESS DOOR OPENING SIZE	ROUGH OPENING SIZE
RD-580009	Ø 9"	15" X 15"
RD-580012	Ø 12"	18" X 18"
RD-580016	Ø 16"	22" X 22"
RD-580018	Ø 18"	24" X 24"
RD-580024	Ø 24"	30" X 30"
RD-580030	Ø 30"	36" X 36"

\* Neoprene Gasket Available Upon Request

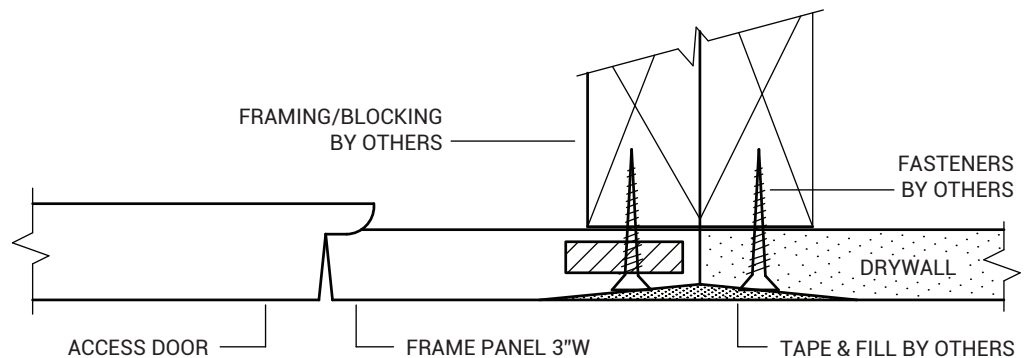
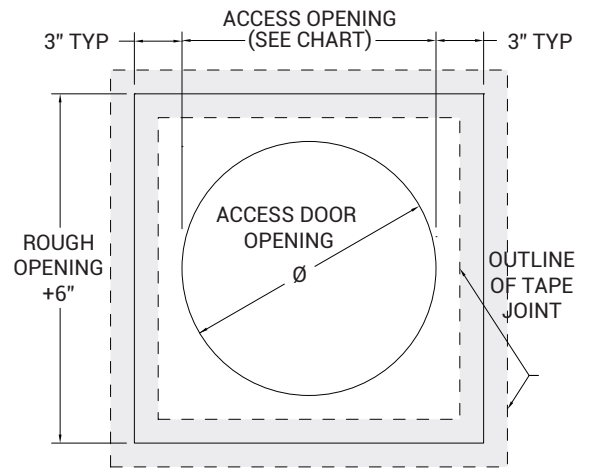

### PROJECT DATA

Custom Sizes Available - Fast!

PROJECT NAME :	QTY	W	H	OPTIONS
ARCHITECT :				
DEALER :				
CONTRACTOR :				
LOCATION :	SPECIAL INSTRUCTIONS :			
DATE :				
TAGGING INSTRUCTIONS :	SUBMITTAL APPROVAL : (signature or stamp)			

Scan or Click



To view Pricing and Additional Product Info.

TELEPHONE:  
1-800-483-0823  
FAX:  
1-888-828-6021

385 WILSON STREET EAST,  
SUITE 302  
ANCASTER, ON, L9G 2C1  
CANADA



WEBSITE:  
[www.BestAccessDoors.ca](http://www.BestAccessDoors.ca)  
E-MAIL:  
[info@bestaccessdoors.ca](mailto:info@bestaccessdoors.ca)