



Quality Access Doors- FAST!

SUBMITTAL/TECHNICAL DATA SHEET

DESCRIPTION

This is a concealed hardware gypsum wallboard access panel that blends seamlessly into your wall or ceiling. Once installed and finished to match the surrounding surface, a clean 1/16" reveal is all that remains visible. All elegant and functional surface treatments can be applied to the door as well. A continuous perimeter gasket in the frame guarantees acoustic integrity of the solid GWB.

APPLICATION

- Drywall, plasterboard, wallboard, gypsum board, sheetrock, or gyprock
- All assemblies clad in 1/2" (12.7 mm) or 5/8" (15.9 mm) board
- Wall or ceiling installation
- New construction or repairs
- Rough openings in GWB without abutting structures
- Maximum clearance with removable door leaf
- This product is not fire rated

FEATURES

- Strong concealed aluminum frame and hardware
- Concealed mechanical touch-latch
- Lift-out doors with safety cables
- Moisture resistant GWB inlay
- Perimeter gasket (air & smoke tight)

HINGE:

- Free pivoting hinge
- Door can be removed for maximum clearance

SOUND TRANSMISSION:

- This access panel will not reduce the STC rating of the assembly

LATCH:

- Concealed touch latch (standard)
- Cam latch (optional)
- Tamper resistant cam latch (optional)
- Keyed lock (optional)

FRAME:

- Recessed aluminum extrusions
- Frame acts as finishing edge
- 1/16" (2mm) Gap between frame and door

SKU: **BAC-BP-II-58**

VIRTUALLY INVISIBLE ACCESS PANEL

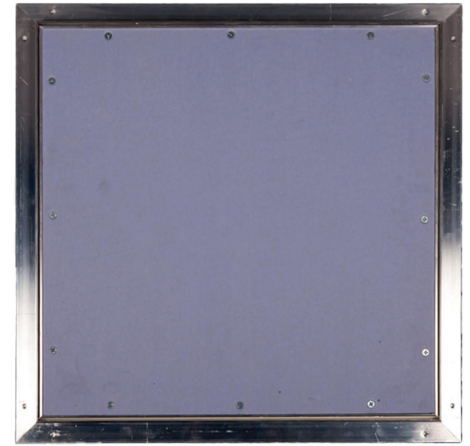

DIMENSIONS AND APPEARANCE

>> CLICK TO VIEW ADDITIONAL DETAILS AND PRICING <<

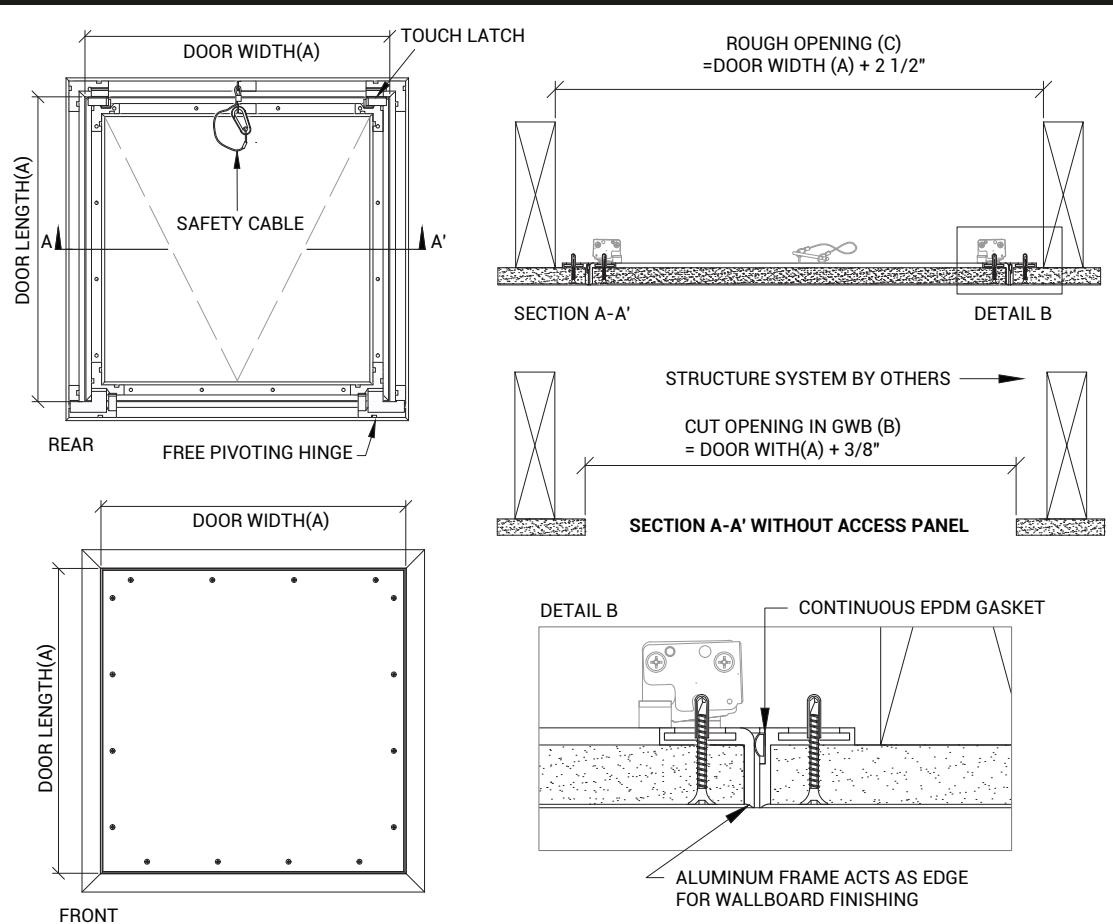

For a complete list of options visit www.BestAccessDoors.ca

PROJECT DATA

Custom Sizes Available - Fast!

PROJECT NAME :	QTY	W	H	OPTIONS
ARCHITECT :				
DEALER :				
CONTRACTOR :				
LOCATION :	SPECIAL INSTRUCTIONS :			
DATE :				
TAGGING INSTRUCTIONS :	SUBMITTAL APPROVAL : (signature or stamp)			

Scan or Click



To view Pricing and Additional Product Info.

TELEPHONE:
1-800-483-0823
FAX:
1-888-828-6021

385 WILSON STREET EAST,
SUITE 302
ANCASTER, ON, L9G 2C1
CANADA



WEBSITE:
www.BestAccessDoors.ca
E-MAIL:
info@BestAccessDoors.ca