

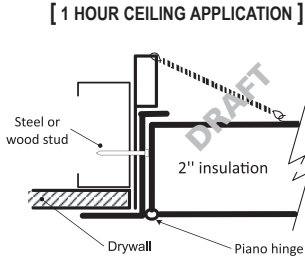

HIGH SECURITY FIRE RATED INSULATED ACCESS DOOR FOR ALL SURFACE TYPES

BA-PFI-HS

INSTALLATION: WALLS AND CEILINGS

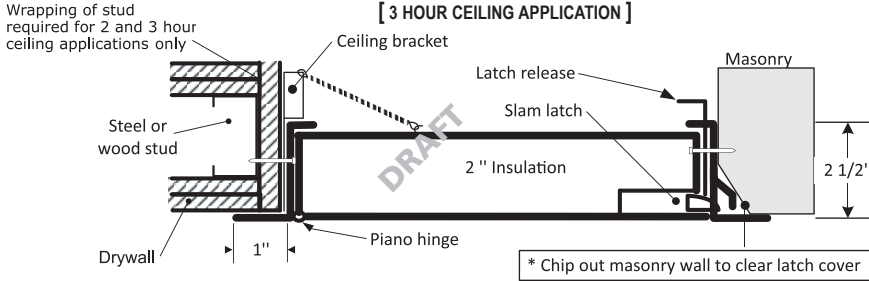

Authorities Having Jurisdiction (AHJ) should be consulted in all cases as to the particular requirements covering the installation and use of fire rated access doors.

DIMENSIONS AND APPEARANCE

LEED ready: This product contributes to LEED® credits.

Your odd sizes: Made in 5 days

| DOOR SIZE W x H inches (MM) | NUMBER OF LOCKS | WEIGHT LBS KG |
|--------------------------------|-----------------|------------------|
| 8 x 8 (203 x 203) | 1 | 7 3.2 |
| 10 x 10 (254 x 254) | 1 | 8 3.6 |
| 12 x 12 (304 x 304) | 1 | 10 4.5 |
| 14 x 14 (355 x 355) | 1 | 12 5.4 |
| 16 x 16 (406 x 406) | 1 | 14 6.4 |
| 18 x 18 (457 x 457) | 1 | 17 7.7 |
| 22 x 22 (558 x 558) | 1 | 20 9.1 |
| 22 x 30 (558 x 762) | 1 | 30 13.6 |
| 22 x 36 (558 x 914) | 2 | 34 15.5 |
| 24 x 24 (609 x 609) | 1 | 28 12.7 |
| 24 x 36 (609 x 914) | 2 | 36 16.4 |
| * 24 x 48 (609 x 1219) | 2 | 48 21.8 |
| * 30 x 30 (762 x 762) | 1 | 40 18.1 |
| * 32 x 32 (812 x 812) | 2 | 43 19.5 |
| * 36 x 36 (914 x 914) | 2 | 50 22.7 |
| * 48 x 48 (1219 x 1219) | 2 | 83 37.7 |

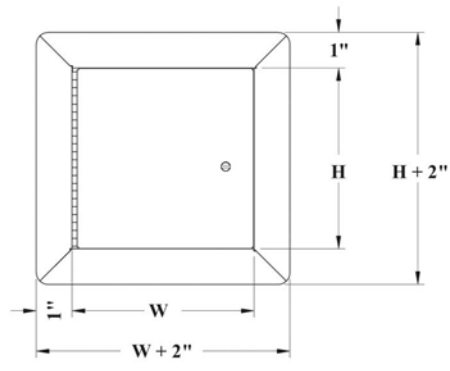

Rough wall opening is door size + 1/4" or + 6mm
*Not available for ceiling rating (maximum 24"x36")



DESCRIPTION AND MATERIAL SPECIFICATION

FIRE RATING: For installation in vertical wall assemblies:
RATING 1 1/2 HOURS. Temperature rise: 250°F (139°C) at 30 mins. and 450°F (250°C) at 60 mins. Maximum door size of 48" x 48".
RATING 3 HOURS. Temperature rise: 400°F at 60 mins. Maximum door size of 48" x 48".

FIRE RATING: For installation in horizontal ceiling assemblies:
WITH TEMPERATURE RISE: Rating 3 hours for non-combustible assembly and 1 hour for combustible assembly: Temperature rise: Max 250°F (139°C) at 30 mins, 450°F (250°C) at 60 mins. Maximum door size of 24" x 36" or 864 sq inches (see note 1)
WITHOUT TEMPERATURE RISE: Rating: 3 hours for non-combustible assembly and 1 hour for combustible assembly.

STANDARDS LISTED: NFPA 252-2003, UL 10(b), UL 555, CAN/ULC S112 M90-R2001, CAN/ULC S104-10, MEA # 507-06-M

Material: 14 gauge cold rolled steel frame and 16 gauge galvaneal steel door
Insulation: mineral wool
Hinge: continuous piano hinge
Lock / latch: Mortise slam latch with cylinder (optional no cylinder)
Inside panel release: Included on all slam latch fire doors
Automatic panel closer: standard on all doors
Finish: high quality white powder coat primer individually wrapped, 1 per box
Packaging:

POPULAR OPTIONS For complete list of options go to: www.BestAccessDoors.com



NOTE 1: Maximum door size 24" x 36" can also be calculated by multiplying the surface area of the door (24"x 36"). The maximum surface area is 864 sq. inches. All door sizes equal to or smaller than 864 sq. inches fall within the standards. In addition, sizing of the doors have a maximum 3" allowance as long as the area of the doors are kept to the minimum requirement.

PROJECT DATA

| PROJECT NAME: | QTY | W | H | OPTIONS |
|-----------------------|---|---|---|---------|
| ARCHITECT: | | | | |
| DEALER: | | | | |
| CONTRACTOR: | | | | |
| LOCATION: | SPECIAL INSTRUCTIONS: | | | |
| DATE: | | | | |
| TAGGING INSTRUCTIONS: | SUBMITTAL APPROVAL: (signature or stamp) | | | |

ADDRESS: P.O Box 4668, #76520 New York, NY 10163-4668
WAREHOUSES: California, Colorado, Florida, Illinois, Pennsylvania, Texas

Tel.: 1-800-483-0823
Fax: 1-888-828-6021

www.bestaccessdoors.com
sales@bestaccessdoors.com